

NEW

CATALOG

SELKIRK
METALBESTOS®

MODEL DCV AL29-4C® DOUBLE-WALL SPECIAL GAS VENT

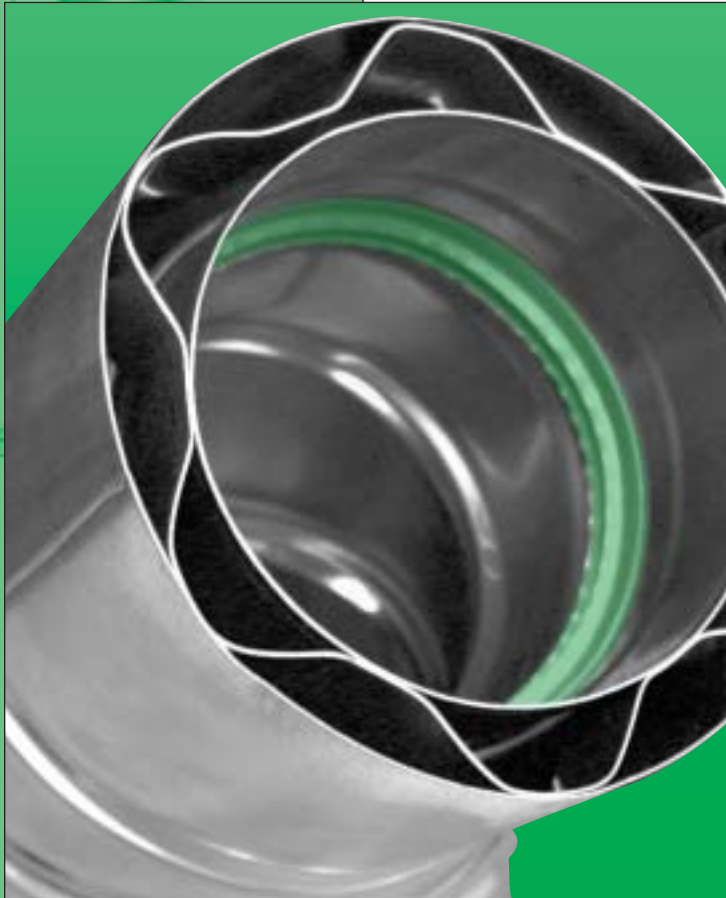

Gas vent system with built-in gaskets designed for use with Category II, III, IV gas fired appliances



- *Easiest to Install*
- *Superior Performance*
- *Built-in mechanical locking band and gasket*
- *Inspection, maintenance or rerouting is a breeze*
- *Cut Installation time by 60%*
- *Meets All UL Requirements*

ProSeal™



Patent # 6,026,803 additional patents pending

Selkirk The Leaders in Venting Technology

Selkirk has been supplying the market with industry leading innovation and service for over 75 years. Selkirk manufactures an extensive line of HVAC products, including AirMate brand air vent registers, grilles, diffusers and Metalbestos brand type B gas vent, flexible connectors, chimney liners and prefabricated chimney systems.

Model DCV is a double-wall gasketed and butt-welded vent system for high efficiency gas fired equipment. Research had indicated that the market needed a product that was safe and reliable, easy to install, cost effective and projected a professional image.

Material Selection and Design

The Model DCV Double Wall Special Gas Vent System is manufactured under the most stringent quality control measures utilizing the latest production technology and know-how. Model DCV is ideally suited for safely removing the products of combustion from high efficiency natural gas or propane fired heating equipment, where low flue gas temperatures can result in significant condensation within the vent system.

The flue gas (inner tube) is made from AL29-4C or 29-4 (S44735), a super-ferritic stainless steel designed for extreme resistance to chloride ion pitting, crevice corrosion and stress corrosion cracking, as well as general corrosion in oxidizing environments. AL29-4C is an ideal choice for resisting harmful effects of corrosive condensates created by partially or fully condensing natural gas and propane fired heating appliances. The Canadian Gas Research Institute confirmed that test results proved AL29-4C to be one of two "most corrosion resistant alloys of twenty candidate stainless steels evaluated for resistance to chloride-induced corrosion in condensing and partially condensing gas-fired appliances". AL29-4C is a registered trademark of Allegheny Ludlum Corp.

The Jacket (outer tube) is manufactured from either type 304 or type 430 stainless steel to provide long lasting performance and stability inside a building or when exposed to the outdoors.

The Air space between the flue gas conduit and jacket is .5 inches, providing close clearances to combustibles, reasonable outside dimensions and an additional heat shield for margin of safety where needed.



"The Model DCV System is fully interchangeable with our Model CV Single-wall System."

UL Listings

Model DCV has been tested and is listed by Underwriters Laboratories, Inc. to UL 1738 and ULC-S636-95 safety standards. When installed according to Selkirks' Systems' installation instructions, Model CV meets all test requirements for horizontal and vertical; interior or exterior installations.

Model DCV Applications

Model DCV is a Special Gas Vent and Gas Vent Connector, designed for use on natural gas or propane-fired appliances listed as Category II, III and IV or in Canada Type BH Gas Vent Systems having a maximum flue gas temperature of 550 degrees F (288 degrees C) and maximum rated positive pressure of 6" water column (tested at 15" water column). Model DCV provides venting for high efficiency gas boilers, furnaces, booster heaters, pool heaters, water heaters, unit heaters or tank-less water heaters and is available in 3", 4", 5", 6", 7", 8", 9", 10", 12", 14" and 16" nominal flue gas conduit diameters. Model DCV may also be used as a vent for Category I, natural gas or propane-fired heaters. (See Installation instructions for details). Model DCV must be sized according to the heating appliance manufacturer's instructions, NFPA 211, NFPA 54, The National Fuel Gas Code ANSI Z223.1 and any other relevant local building codes and regulations (see installation instructions for details!). Model DCV Applications

FEATURES

AL29-4C® super-ferritic stainless steel*

Precision welded butt seam

Factory installed replaceable gaskets

Factory built-in locking band

Wall Thimble with built-in Adjustable Vent Length

Standard Adjustable Vent Length

Proven track record

BENEFITS

- Widely recognized as the material of choice for condensing appliances.

- Excellent corrosion resistance and structural strength.

- Seams on vent lengths and components are smooth both inside and out. Gas and water-tight.

- System can be taken apart and reassembled quickly.
- No silicone, no toxic fumes, no cure time, no mess.
- Installs in less than 1/3 the normal installation time.

- Line up seams to line up clamps for easy installation.
- No cumbersome tabs.
- No external clamps to lose.

- Wall Thimble allows for built-in horizontal adjustments.
- No need to cut pipe.

- Provides 4" - 12" of adjustment for easy system pitching.

- Tested and listed by Underwriters Laboratories, Inc. to UL 1738 and ULC-S636.

- Tested and approved by heating equipment manufacturers.

- 15 year warranty.





Metalbestos Model DCV – An Installer’s Dream Come True!

Each vent length and component features a built-in mechanical locking band and our exclusive ProSeal gasket. Parts are simply slid together to a stop bead, which renders the joints air and water-tight. By tightening their integrated mechanical locking band, parts are securely fastened together in seconds. Model DCV can be taken apart and reassembled in minutes, making inspection, maintenance or rerouting of the system a breeze. Should a part or gasket ever become damaged, replacement takes less than five minutes and the integrity of the system is not compromised! Adjustable vent lengths integrated in our Wall Thimbles allow for built-in horizontal adjustments without the need for cutting pipe. Our standard Adjustable Vent Length can be slid vertically from 4" to 12", permitting Model CV to be pitched to properly drain condensation. Connecting Model DCV to an appliance is done efficiently with one of our many Appliance Adapters approved by each individual heating appliance manufacturers. Heating equipment can be fired up immediately upon completing an installation, as no cure time or cleanup is required. Model DCV parts require no cutting, no exterior clamps, no joints to wipe with alcohol, no rings, no tabs, no mess to clean. No toxic fumes to inhale while working at dangerous heights installing the vent system.

Model DCV is Built for Performance

Model DCV features a smooth weld seam inside and out, which is completely shielded during the welding process. Contamination or molecular changes in the weld seam are avoided; no fillers are used in the welding process. Tube ends are formed under the most stringent quality standards to guarantee a perfect fit every time and to avoid built-in stress points or weak areas. Model DCV is an Installer’s Dream Come True!



Model DCV Technical Support is Second to None

For complicated installations, communicate your specifications to Selkirk and we will supply computer aided drawings (CAD) and a complete bill of materials within 72 hours. Unless your specs are changed more than once, this service is provided free of charge. For technical or marketing information you may visit our website at www.selkirkinc.com. E-mail our technical department at metalbestosupport@selkirkinc.com. Should you prefer to communicate directly, call us at 800.992.VENT (8368).

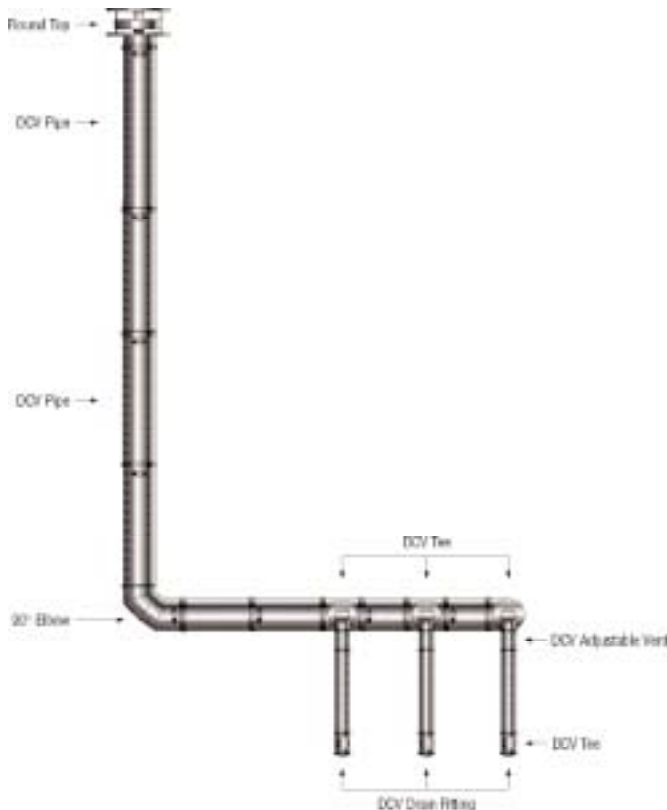

CLEARANCE TO COMBUSTIBLES					
Systems Operating Temperatures		Minimum Clearance to Combustibles Enclosed		Clearance Unenclosed	
		H	V	H	V
3" to 16"	300°	3"	3"	1"	1"
3" & 4"	480°F	6"	4"	3"	3"
5" to 16"	480°F	6"	6"	3"	3"

MATERIAL THICKNESS AL29-4C®	
3" - 7" (76.2mm – 177.8)	.016" (.4mm)
8" - 12" (203.2mm – 304.8)	.020" (.5mm)
14" - 16" (355.6mm – 406.4)	.024" (.6mm)

Model DCV Double Wall Pipe Lengths

a (in)	b (in)	c (in)	Product No.	Part No.
3	6.00	4.25	3203006	3DCV-6
	12.00	10.25	3203012	3DCV-12
	18.00	16.25	3203018	3DCV-18
	24.00	22.25	3203024	3DCV-24
	36.00	34.25	3203036	3DCV-36

a (in)	b (in)	c (in)	Product No.	Part No.
4	6.00	4.25	3204006	4DCV-6
	12.00	10.25	3204012	4DCV-12
	18.00	16.25	3204018	4DCV-18
	24.00	22.25	3204024	4DCV-24
	36.00	34.25	3204034	4DCV-36

a (in)	b (in)	c (in)	Product No.	Part No.
5	6.00	4.25	3205006	5DCV-6
	12.00	10.25	3205012	5DCV-12
	18.00	16.25	3205018	5DCV-18
	24.00	22.25	3205024	5DCV-24
	36.00	34.25	3205036	5DCV-36

a (in)	b (in)	c (in)	Product No.	Part No.
6	6.00	4.25	3206006	6DCV-6
	12.00	10.25	3206012	6DCV-12
	18.00	16.25	3206018	6DCV-18
	24.00	22.25	3206024	6DCV-24
	36.00	34.25	3206036	6DCV-36

a (in)	b (in)	c (in)	Product No.	Part No.
7	6.00	4.25	3207006	7DCV-6
	12.00	10.25	3207012	7DCV-12
	18.00	16.25	3207018	7DCV-18
	24.00	22.25	3207024	7DCV-24
	36.00	34.25	3207036	7DCV-36

a (in)	b (in)	c (in)	Product No.	Part No.
8	6.00	4.25	3208006	8DCV-6
	12.00	10.25	3208012	8DCV-12
	18.00	16.25	3208018	8DCV-18
	24.00	22.25	3208024	8DCV-24
	36.00	34.25	3208036	8DCV-36

a (in)	b (in)	c (in)	Product No.	Part No.
9	6.00	4.25	3209006	9DCV-6
	12.00	10.25	3209012	9DCV-12
	18.00	16.25	3209018	9DCV-18
	24.00	22.25	3209024	9DCV-24
	36.00	34.25	3209036	9DCV-36

a (in)	b (in)	c (in)	Product No.	Part No.
10	6.00	4.25	3210006	10DCV-6
	12.00	10.25	3210012	10DCV-12
	18.00	16.25	3210018	10DCV-18
	24.00	22.25	3210024	10DCV-24
	36.00	34.25	3210036	10DCV-36

a (in)	b (in)	c (in)	Product No.	Part No.
12	6.00	4.25	3212006	12DCV-6
	12.00	10.25	3212012	12DCV-12
	18.00	16.25	3212018	12DCV-18
	24.00	22.25	3212024	12DCV-24
	36.00	34.25	3212036	12DCV-36

a (in)	b (in)	c (in)	Product No.	Part No.
14	6.00	4.25	3214006	14DCV-6
	12.00	10.25	3214012	14DCV-12
	18.00	16.25	3214018	14DCV-18
	24.00	22.25	3214024	14DCV-24
	36.00	34.25	3214036	14DCV-36

a (in)	b (in)	c (in)	Product No.	Part No.
16	6.00	4.25	3216006	16DCV-6
	12.00	10.25	3216012	16DCV-12
	18.00	16.25	3216018	16DCV-18
	24.00	22.25	3216024	16DCV-24
	36.00	34.25	3216036	16DCV-36

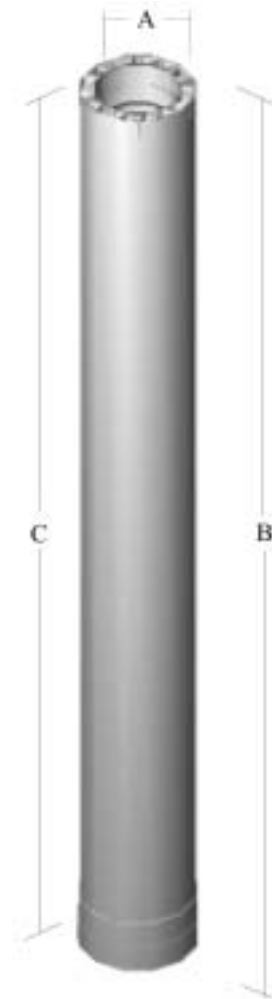

Note:

Couplers on pipe & fittings overlap 1 3/4" when joined.

Stop bead on male end must be pushed directly against the flared portion of the female end.

Lining up the seams on the sections of pipe will line up the integrated mechanical locking bands - providing extra ease of installation!

*AL29-4C® is a registered Trademark of Allegheny Ludlum, Inc.

Model DCV 45° Elbow

a (in)	b (in)	c (in)	Product No.	Part No.
3	4.50	2.75	3203215	3DCV-EL45
4	4.50	2.75	3204215	4DCV-EL45
5	5.00	3.00	3205215	5DCV-EL45
6	5.50	3.25	3206215	6DCV-EL45
7	6.50	3.50	3207215	7DCV-EL45
8	7.00	4.00	3208215	8DCV-EL45
9	7.50	4.00	3209215	9DCV-EL45
10	8.00	4.00	3210215	10DCV-EL45
12	8.25	4.00	3212215	12DCV-EL45
14	9.00	4.50	3214215	14DCV-EL45
16	9.75	5.00	3216215	16DCV-EL45



Model DCV 90° Elbow

a (in)	b (in)	c (in)	Product No.	Part No.
3	4.50	6.50	3203230	3DCV-EL90
4	4.50	6.50	3204230	4DCV-EL90
5	4.75	6.75	3205230	5DCV-EL90
6	5.75	7.00	3206230	6DCV-EL90
7	6.25	7.50	3207230	7DCV-EL90
8	6.75	8.25	3208230	8DCV-EL90
9	7.25	9.50	3209230	9DCV-EL90
10	7.75	10.50	3210230	10DCV-EL90
12	8.50	10.75	3212230	12DCV-EL90
14	9.75	11.00	3214230	14DCV-EL90
16	11.00	13.00	3216230	16DCV-EL90



Model DCV Tee

a (in)	b (in)	c (in)	Product No.	Part No.
3	7.25	4.50	3203100	3DCV-TS
4	8.25	5.00	3204100	4DCV-TS
5	10.25	6.00	3205100	5DCV-TS
6	10.25	6.00	3206100	6DCV-TS
7	12.25	7.00	3207100	7DCV-TS
8	14.25	8.00	3208100	8DCV-TS
9	14.25	8.00	3209100	9DCV-TS
10	16.25	9.00	3210100	10DCV-TS
12	16.25	9.00	3212100	12DCV-TS
14	20.25	11.00	3214100	14DCV-TS
16	22.25	12.00	3216100	16DCV-TS

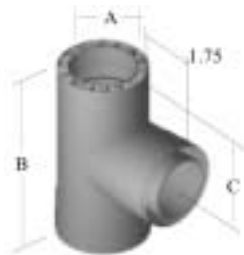

Model DCV Tee Caps

a (in)	b (in)	c (in)	Product No.	Part No.
3	3.50	–	3203180	3DCV-TC
4	3.50	–	3204180	4DCV-TC
5	3.50	–	3205180	5DCV-TC
6	3.50	–	3206180	6DCV-TC
7	3.50	–	3207180	7DCV-TC
8	3.50	–	3208180	8DCV-TC
9	3.50	–	3209180	9DCV-TC
10	3.50	–	3210180	10DCV-TC
12	3.50	–	3212180	12DCV-TC
14	3.50	–	3214180	14DCV-TC
16	3.50	–	3216180	16DCV-TC

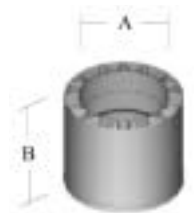

Model DCV Drain Fitting

a (in)	b (in)	c (in)	Product No.	Part No.
3	3.50	–	3203510	3DCV-DF
4	3.50	–	3204510	4DCV-DF
5	3.50	–	3205510	5DCV-DF
6	3.50	–	3206510	6DCV-DF
7	3.50	–	3207510	7DCV-DF
8	3.50	–	3208510	8DCV-DF
9	3.50	–	3209510	9DCV-DF
10	3.50	–	3210510	10DCV-DF
12	3.50	–	3212510	12DCV-DF
14	3.50	–	3214510	14DCV-DF
16	3.50	–	3216510	16DCV-DF



Model DCV Adjustable Vent Length (4" to 12")

a (in)	b (in)	c (in)	Product No.	Part No.
3	18.00	–	3203082	3DCV-AJ
4	18.00	–	3204082	4DCV-AJ
5	18.00	–	3205082	5DCV-AJ
6	18.00	–	3206082	6DCV-AJ
7	18.00	–	3207082	7DCV-AJ
8	18.00	–	3208082	8DCV-AJ
9	18.00	–	3209082	9DCV-AJ
10	18.00	–	3210082	10DCV-AJ
12	18.00	–	3212082	12DCV-AJ
14	18.00	–	3214082	14DCV-AJ
16	18.00	–	3216082	16DCV-AJ



NOTE: Also use to easily adjust pitch on horizontal and vertical runs of pipe. When used with another length of pipe, the DCV-AJ will adjust from 4" to 12". Plate serves as a fire stop.

Model DCV Wall Thimble w/Integrated Adjustable Vent Length

a (in)	b (in)	c (in)	Product No.	Part No.
3	9.00	18.00	3203705	3DCV-WT
4	10.00	18.00	3204705	4DCV-WT
5	16.00	18.00	3205705	5DCV-WT
6	17.00	18.00	3206705	6DCV-WT
7	18.00	18.00	3207705	7DCV-WT
8	18.00	18.00	3208705	8DCV-WT
9	20.00	18.00	3209705	9DCV-WT
10	21.00	18.00	3210705	10DCV-WT
12	22.00	18.00	3212705	12DCV-WT
14	24.00	18.00	3214705	14DCV-WT
16	26.00	18.00	3216705	16DCV-WT

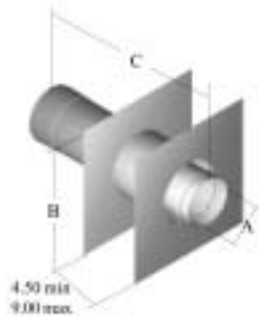

Model CV Firestop/Masonry Flashing

a (in)	b (in)	c (in)	Product No.	Part No.
3	4	15.00	3003400	3CV-FF
4	5	17.00	3004400	4CV-FF
5	6	17.00	3005400	5CV-FF
6	7	19.00	3006400	6CV-FF
7	8	19.00	3007400	7CV-FF
8	9	22.00	3008400	8CV-FF
9	10	22.00	3009400	9CV-FF
10	11	23.00	3010400	10CV-FF
12	12	25.00	3012400	12CV-FF
13	14	27.00	3013400	13CV-FF
14	15	27.00	3014400	14CV-FF
15	16	-	3015400	15CV-FF
16	14	29.00	3016400	16CV-FF
17	18	-	3015400	17CV-FF

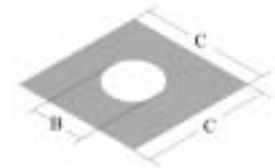

Model CV Tall Cone Roof Flashing

a (in)	b (in)	c (in)	Product No.	Part No.
3	4	16.00	3003815	3CV-TF
4	5	17.00	3004815	4CV-TF
5	6	18.00	3005815	5CV-TF
6	7	19.00	3006815	6CV-TF
7	8	20.00	3007815	7CV-TF
8	9	21.00	3008815	8CV-TF
9	10	22.00	3009815	9CV-TF
10	11	23.00	3010815	10CV-TF
12	13	25.00	3012815	12CV-TF
14	15	27.00	3014815	14CV-TF
16	17	29.00	3016815	16CV-TF

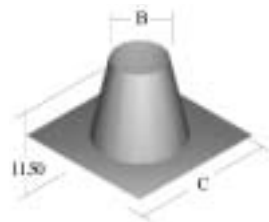

Model CV Adjustable Roof Flashing Up to 6/12 Pitch

a (in)	b (in)	c (in)	Product No.	Part No.
3	5	16.00	3003825	3CV-AF
4	6	17.00	3004825	4CV-AF
5	7	18.00	3005825	5CV-AF
6	8	19.00	3006825	6CV-AF
7	9	20.00	3007825	7CV-AF
8	10	21.00	3008825	8CV-AF
9	11	22.00	3009825	9CV-AF
10	12	23.00	3010825	10CV-AF
12	14	25.00	3012825	12CV-AF
14	16	27.00	3014825	14CV-AF
16	18	29.00	3016825	16CV-AF

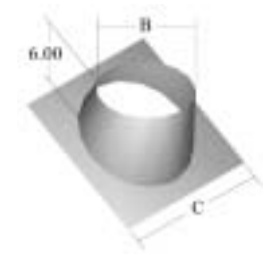

Model CV Bird Screen

a (in)	b (in)	c (in)	Product No.	Part No.
3	2.25	-	3003550	3CV-BS
4	2.25	-	3004550	4CV-BS

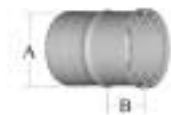

Model DCV 22.5° Bird Screen

a (in)	b (in)	c (in)	Product No.	Part No.
5	3.50	-	3005550	5CV-BS
6	4.50	-	3006550	6CV-BS
7	5.75	-	3007550	7CV-BS
8	6.50	-	3008550	8CV-BS
9	7.50	-	3009550	9CV-BS
10	8.50	-	3010550	10CV-BS
12	10.25	-	3012550	12CV-BS
14	12.25	-	3014550	14CV-BS
16	14.25	-	3016550	16CV-BS

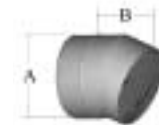

Model CV Termination Tee

a (in)	b (in)	c (in)	Product No.	Part No.
3	6.00	3.0	3003500	3CV-TT
4	7.00	3.5	3004500	4CV-TT
5	8.00	4.0	3005500	5CV-TT
6	9.00	4.5	3006500	6CV-TT

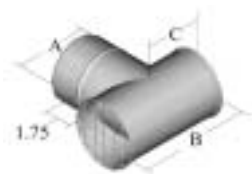

Model DCV Round Top

a (in)	b (in)	c (in)	Product No.	Part No.
3	4.25	6	3203800	3DCV-RT
4	5.25	8	3204800	4DCV-RT
5	5.25	11	3205800	5DCV-RT
6	5.25	13	3206800	6DCV-RT
7	5.25	15	3207800	7DCV-RT
8	5.25	17	3208800	8DCV-RT
9	6.25	19	3209800	9DCV-RT
10	6.75	21	3210800	10DCV-RT
12	7.75	25	3212800	12DCV-RT
14	8.75	29	3214800	14DCV-RT
16	10.75	33	3216800	16DCV-RT

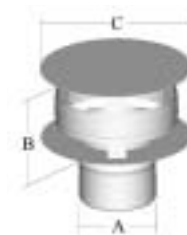

Model CV Support Clamp

a (in)	b (in)	c (in)	Product No.	Part No.
3	4	1.50	3003440	3CV-SCL
4	5	1.50	3004440	4CV-SCL
5	6	1.50	3005440	5CV-SCL
6	7	1.50	3006440	6CV-SCL
7	8	1.50	3007440	7CV-SCL
8	9	1.50	3008440	8CV-SCL
9	10	1.50	3009440	9CV-SCL
10	11	1.50	3010440	10CV-SCL
11	12	1.50	3011440	11CV-SCL
12	13	1.50	3012440	12CV-SCL
13	14	1.50	3013440	13CV-SCL
14	15	1.50	3014440	14CV-SCL
15	14	1.50	3015440	15CV-SCL
16	17	1.50	3016440	16CV-SCL
17	18	1.50	3017440	17CV-SCL



Model CV Storm Collar

a (in)	b (in)	c (in)	Product No.	Part No.
3	4	-	3003810	3CV-SC
4	5	-	3004810	4CV-SC
5	6	-	3005810	5CV-SC
6	7	-	3006810	6CV-SC
7	8	-	3007810	7CV-SC
8	9	-	3008810	8CV-SC
9	10	-	3009810	9CV-SC
10	11	-	3010810	10CV-SC
12	13	-	3012810	12CV-SC
14	15	-	3014810	14CV-SC
16	17	-	3016810	16CV-SC

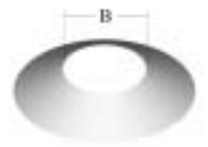

Model CV Wall Band/Bracket

a (in)	b (in)	c (in)	Product No.	Part No.
3	4	4.00	3003430	3CV-WB
4	5	4.50	3004430	4CV-WB
5	6	5.00	3005430	5CV-WB
6	7	5.50	3006430	6CV-WB
7	8	6.00	3007430	7CV-WB
8	9	6.50	3008430	8CV-WB
9	10	7.00	3009430	9CV-WB
10	11	7.50	3010430	10CV-WB
11	-	-	3011430	9CV-WB
12	13	8.50	3012430	14CV-WB
13	14	-	3013430	9CV-WB
14	15	9.50	3014430	14CV-WB
17	18	-	3017430	9CV-WB

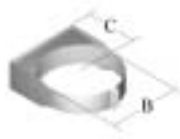

Model DCV 100 ft. Support Hanger

a (in)	b (in)	c (in)	Product No.	Part No.
-	-	-	3000000	CV-SH100

Same for all sizes



Model CV 4" to 3" Reducers

a (in)	b (in)	c (in)	Product No.	Part No.
3	4.25	4.00	3004363	4CV-R3



Model CV 3" to 4" Increasers

a (in)	b (in)	c (in)	Product No.	Part No.
4	4.25	3.00	3003304	3CV-I4



Model DCV Single Wall to Double Wall Adapter

a (in)	b (in)	c (in)	Product No.	Part No.
3	6	4.25	3203245	3DCV-DWA/SW
4	5	4.25	3204245	4DCV-DWA/SW
5	6	4.25	3205245	5DCV-DWA/SW
6	7	4.25	3206245	6DCV-DWA/SW
7	8	4.25	3207245	7DCV-DWA/SW
8	9	4.25	3208245	8DCV-DWA/SW
9	10	4.25	3209245	9DCV-DWA/SW
10	11	4.25	3210245	10DCV-DWA/SW
12	13	4.25	3212245	12DCV-DWA/SW
14	15	4.25	3214245	16DCV-DWA/SW
16	6	4.25	3216245	16DCV-DWA/SW

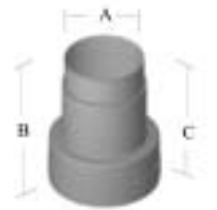

Model DCV Single Wall to Double Wall Adapter

a (in)	b (in)	c (in)	Product No.	Part No.
3	6	4.25	3003245	3DCV-SWA/DW
4	6	4.25	3004245	4DCV-SWA/DW
5	6	4.25	3005245	5DCV-SWA/DW
6	6	4.25	3006245	6DCV-SWA/DW
7	6	4.25	3007245	7DCV-SWA/DW
8	6	4.25	3008245	8DCV-SWA/DW
9	6	4.25	3009245	9DCV-SWA/DW
10	6	4.25	3010245	10DCV-SWA/DW
12	6	4.25	3012245	12DCV-SWA/DW
14	6	4.25	3014245	14DCV-SWA/DW
16	6	4.25	3016245	16DCV-SWA/DW



Model DCV Appliance Adapter

a (in)	b (in)	c (in)	Product No.	Part No.
3	-	-	3203240	3DCV-AA
4	-	-	3204240	4DCV-AA
5	-	-	3205240	5DCV-AA
6	-	-	3206240	6DCV-AA
7	-	-	3207240	7DCV-AA
8	-	-	3208240	8DCV-AA
9	-	-	3209240	9DCV-AA
10	-	-	3210240	10DCV-AA
12	-	-	3212240	12DCV-AA
14	-	-	3214240	14DCV-AA
16	-	-	3216240	16DCV-AA

WORLD HEADQUARTERS

14801 Quorum Drive
Dallas, Texas 75254-7584
(800) 992-VENT (8368)
Fax: (972) 560-2258
www.selkirkinc.com

SALES OFFICES & CUSTOMER SERVICE

UNITED STATES

14801 Quorum Drive
Dallas, Texas 75254-7584
(800) 992-VENT (8368)
Fax: (972) 560-2258
Toll Free Fax: (877) 393-4145

CANADA

375 Green Road
Stoney Creek, Ontario
Canada L8E 4A5
(905) 662-6600
Fax: (905) 662-5352

RESEARCH & DEVELOPMENT

St. Rt. 93 at Sutton Rd.
Logan, Ohio 43138
(740) 385-5666 ext. 203
Fax: (740) 385-2483

RESEARCH & DEVELOPMENT/ MANUFACTURING

UNITED STATES

St. Rt. 93 N. & Sutton Rd.
Logan, Ohio 43138
(740)385-5666
Fax: (800)972-1421

1820 E. Fargo Ave.
Nampa, Idaho 83687-6824
(208)467-7411
Fax: (208)467-7412

7571 West Highway 153
P.O. Box 427
Winters, Texas 79567
(915)754-4571
Fax: (915)754-4764

CANADA

1400 California Ave.
P.O. Box 160, Brockville, Ontario
Canada K6V 5V3
(613)342-6655
(800)267-8178
Fax: (613)342-2735

MEXICO

Justo Sierra Y 2 da Avenida
Ojinaga, Chihuahua, Mexico
011 52 14 532 884/85
Fax: 011 52 14 532 886

TECHNICAL SUPPORT

REGISTER, GRILLE & DIFFUSER
(972) 661-0308
Fax: (972) 661-0164
Email: Airmatesupport@selkirkinc.com

CHIMNEY & VENTING

(800) 848-2149 ext. 212
Fax: (740) 385-9066
Email: Metalbestosupport@selkirkinc.com

BUILT FOR PERFORMANCE...

THE METALBESTOS MODEL CV IS AN INSTALLER'S DREAM COME TRUE!

Model CV is manufactured from AL29-4C[®], a super-ferritic stainless steel designed for extreme resistance to chloride ion pitting, crevice corrosion and stress corrosion cracking, as well as general corrosion in oxidizing environments. AL29-4C[®] is an ideal choice for resisting deleterious effects of corrosive condensates created by partially or fully condensing high efficiency natural gas and propane fired heating appliances.

The Canadian Gas Research Institute found that test results proved AL29-4C[®] to be one of two "most corrosion resistant alloys of twenty candidate stainless steels evaluated for resistance to chloride-induced corrosion in condensing and partially condensing

gas-fired appliances". AL29-4C[®] is patented and manufactured by Allegheny Ludlum Corp.

Model CV has been tested and is listed by Underwriters Laboratories, Inc. to UL 1738 and ULC-S636-95.

Each vent length and component features a built-in mechanical locking band and our exclusive ProSeal gasket. Parts are simply slid together to a stop bead, which renders the joints air and water-tight. By tightening their integrated mechanical locking band, parts are securely fastened together in seconds. Model CV can be taken apart and reassembled in minutes, making inspection, maintenance or rerouting of the system a breeze.

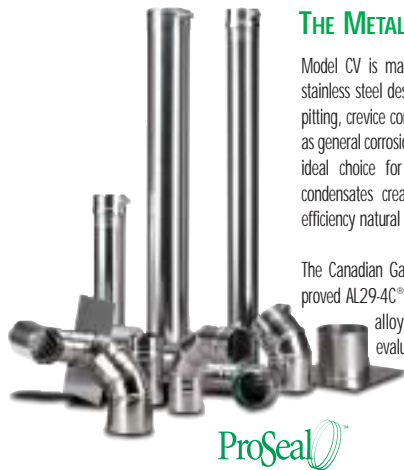

*AL29-4C[®] is a registered Trademark of Allegheny Ludlum, Inc.

METALBESTOS MODEL DCV 15 YEAR WARRANTY

Selkirk L.L.C. warrants the Model DCV Special Gas Vent System to be free of defects in material, manufacturer's workmanship. This is a limited warranty subject to the following time periods and conditions.



WARRANTY PERIOD

The warranty period is fifteen (15) years from the date of installation, when used for venting listed Category II, III or IV gas heating equipment or water heaters which specify this type of venting system.

CONDITIONS

The Model DCV warrant is subject to the following conditions:

- 1) The vent system is installed according to the manufacturer's written instructions.
- 2) The use of the vent system is limited to those appliances for which it is intended.
- 3) The vent system is inspected and maintained annually, beginning one year after the date of installation and continuing throughout the warranty period.

If the Model DCV Special Gas Vent System does not meet conditions of the warranty specified above, and assuming normal and proper installation,

use and maintenance, the buyer shall promptly notify Selkirk in writing. Selkirk shall there upon correct any defect at its expense by replacing any defective or damaged parts of the system supplied under this contract. This obligation, however, is limited to replacement parts and does not include any responsibility or obligation with respect to the shipment, removal or installation of the replaced system or parts. The warranty period for replacement shall run from the date of the original installation of the original system.

These warranties are exclusive and in lieu of all other warranties, whether written, oral, implied or statutory. *Selkirk makes no other expressed, implied or statutory warranties to the buyer*

The foregoing shall constitute the only remedies to the buyer for claims based on a defect in, or failure of the system or its components, whether said claims are designated as arising in contract, warranty, tort (including negligence), strict liability, indemnity, or otherwise. Upon the expiration of the warranty period, all such liability shall terminate. *Liabilities for special, consequential, or incidental damages are expressly excluded.* Selkirk L.L.C. does not warrant the system or its components against normal wear and tear due to operation or environment.

www.selkirkinc.com
800-992-VENT (8368)



SELKIRK L.L.C. is a leading manufacturer of venting products for residential, commercial and industrial applications. Current operations include locations in the United States, Canada and Mexico. SELKIRK has been supplying the finest venting products for over 75 years.