

# STRAIGHT TUBE BUNDLE

## BAFFLE CUT ORIENTATION

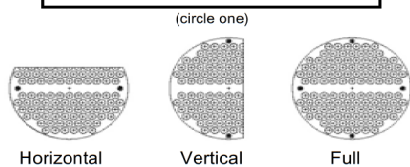

NUMBER OF BAFFLES:

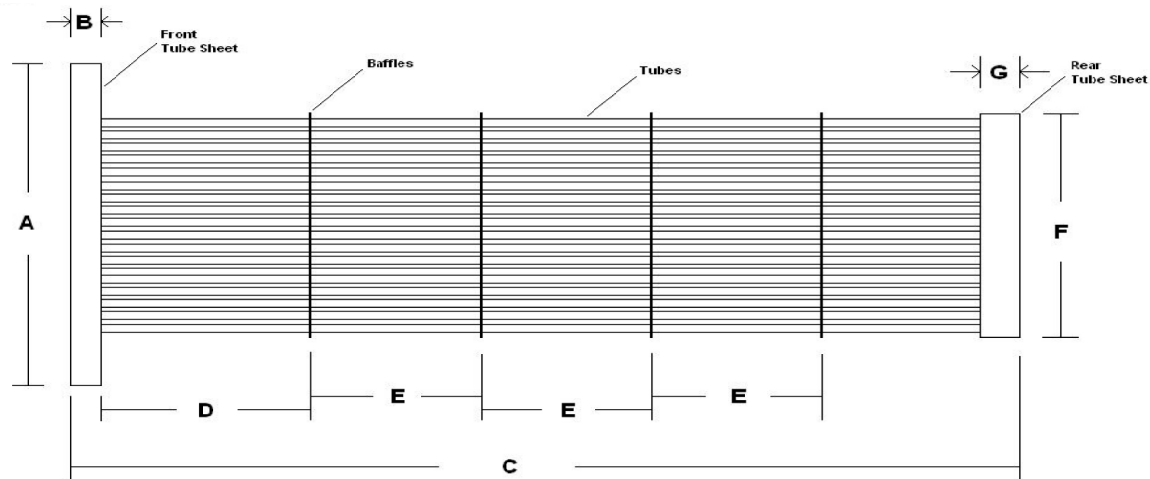

## DIMENSIONAL INFORMATION:

A:	B:	C:	D:	E:	F:

## MATERIALS OF CONSTRUCTION:

FRONT TUBE SHEET:	REAR TUBE SHEET:	TUBE OD & THICKNESS:	TUBE MATERIAL:	BAFFLES:

## BOLTING INFORMATION:(if applicable)

NUMBER OF BOLTS:	
BOLT HOLE DIAMETER:	
BOLTING MATERIAL:	
BOLT CIRCLE DIAMETER:	

## ADDITIONAL INFORMATION:

NUMBER OF U-TUBES:	
NO. OF TUBESIDE PASSES:	
NOTES:	

(Check Appropriate Boxes)	Tubeside	Shellside	CURRENT UNIT:	Contact Information:
Water				Company:
Domestic Water			Manufacturer:	Name:
High-Temp. Water				Phone:
Low-Pressure Steam			Model Number:	Email:
High-Pressure Steam				Date:



**SHCRAFT COMPANY**

Dallas Office: 214-361-6611  
Fax: 214-368-5516

7027 Twin Hills Ave  
Dallas, TX 75231

# U-TUBE BUNDLE (in shell/service)

## BAFFLE CUT ORIENTATION

(circle one)



Horizontal

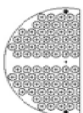

Vertical

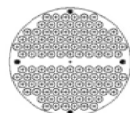

Full

NUMBER OF BAFFLES:

## NUMBER OF PASSES

(circle one)

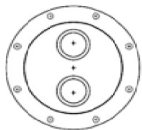

2-Pass

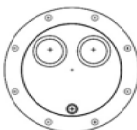

4-Pass

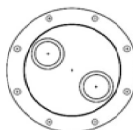

6-Pass

## BOLTING INFORMATION:

(circle one)

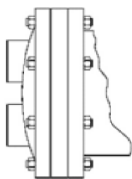

Full Face

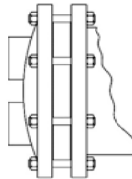

Boltless Tube Sheet

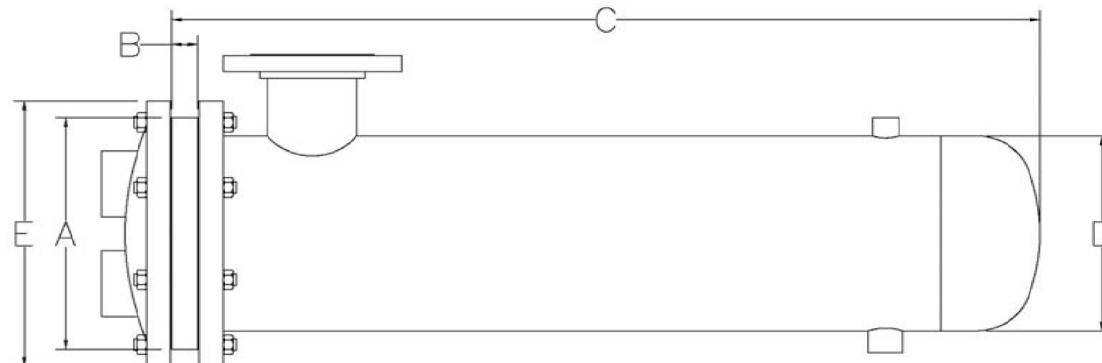

## DIMENSIONAL INFORMATION:

A:	B:	C:	D:	E:

## MATERIALS OF CONSTRUCTION:

TUBE SHEET:	U-TUBES (MATERIAL):	TUBE OD & THICKNESS:	BAFFLES:

## BOLTING INFORMATION: (if applicable)

NUMBER OF BOLTS:	
BOLT HOLE DIAMETER:	
BOLTING MATERIAL:	
BOLT CIRCLE DIAMETER:	

## ADDITIONAL NOTES:

(Check Appropriate Boxes)	<u> Tubeside </u>	<u> Shellside </u>	<u> CURRENT UNIT: </u>	<u> Contact Information: </u>	
Water				Company:	
Domestic Water			Manufacturer:	Name:	
High-Temp. Water				Phone:	
Low-Pressure Steam			Model Number:	Email:	
High-Pressure Steam				Date:	



**SHCRAFT COMPANY**

Dallas Office: 214-361-6611  
Fax: 214-368-5516

7027 Twin Hills Ave  
Dallas, TX 75231

## U-TUBE BUNDLE (in tank/service)

### BAFFLE CUT ORIENTATION

(circle one)

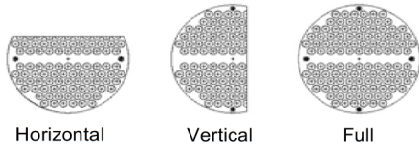

Horizontal

Vertical

Full

NUMBER OF BAFFLES:

### NUMBER OF PASSES

(circle one)

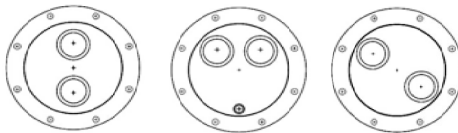

2-Pass

4-Pass

6-Pass

### BOLTING INFORMATION:

(circle one)

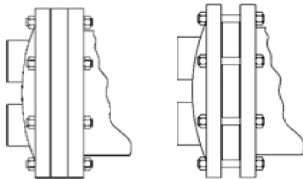

Full Face

Boltless Tube Sheet

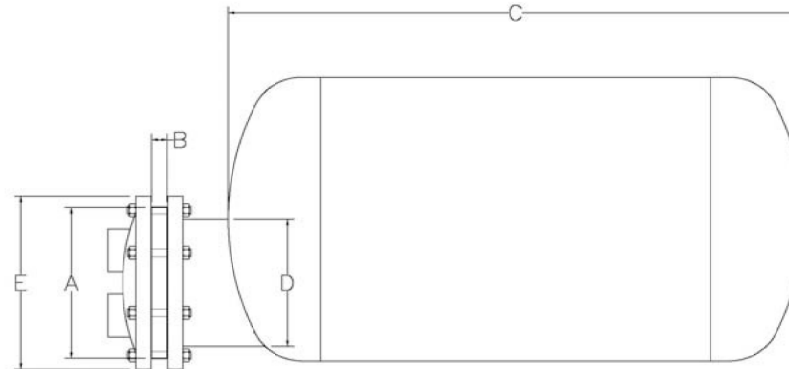

### DIMENSIONAL INFORMATION:

A:	B:	C:	D:	E:
<input style="width: 100px;" type="text"/>	<input style="width: 100px;" type="text"/>	<input style="width: 100px;" type="text"/>	<input style="width: 100px;" type="text"/>	<input style="width: 100px;" type="text"/>

### MATERIALS OF CONSTRUCTION:

TUBE SHEET:	U-TUBES (MATERIAL):	TUBE OD & THICKNESS:	BAFFLES:
<input style="width: 100px;" type="text"/>	<input style="width: 100px;" type="text"/>	<input style="width: 100px;" type="text"/>	<input style="width: 100px;" type="text"/>

### BOLTING INFORMATION: (if applicable)

NUMBER OF BOLTS:	<input style="width: 150px;" type="text"/>
BOLT HOLE DIAMETER:	<input style="width: 150px;" type="text"/>
BOLTING MATERIAL:	<input style="width: 150px;" type="text"/>
BOLT CIRCLE DIAMETER:	<input style="width: 150px;" type="text"/>

### ADDITIONAL NOTES:

(Check Appropriate Boxes) <b>Water</b> <b>Domestic Water</b> <b>High-Temp. Water</b> <b>Low-Pressure Steam</b> <b>High-Pressure Steam</b>	<u>Tubeside</u>	<u>Shellside</u>	<u>CURRENT UNIT:</u>	<u>Contact Information:</u>		 Dallas Office: 214-361-6611 Fax: 214-368-5516 7027 Twin Hills Ave Dallas, TX 75231
			Manufacturer:	Company:		
				Name:		
			Model Number:	Phone:		
				Email:		
			Date:			

# U-TUBE BUNDLE (out of shell/tank)

## BAFFLE CUT ORIENTATION

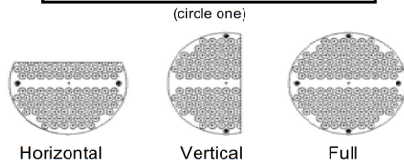

NUMBER OF BAFFLES:

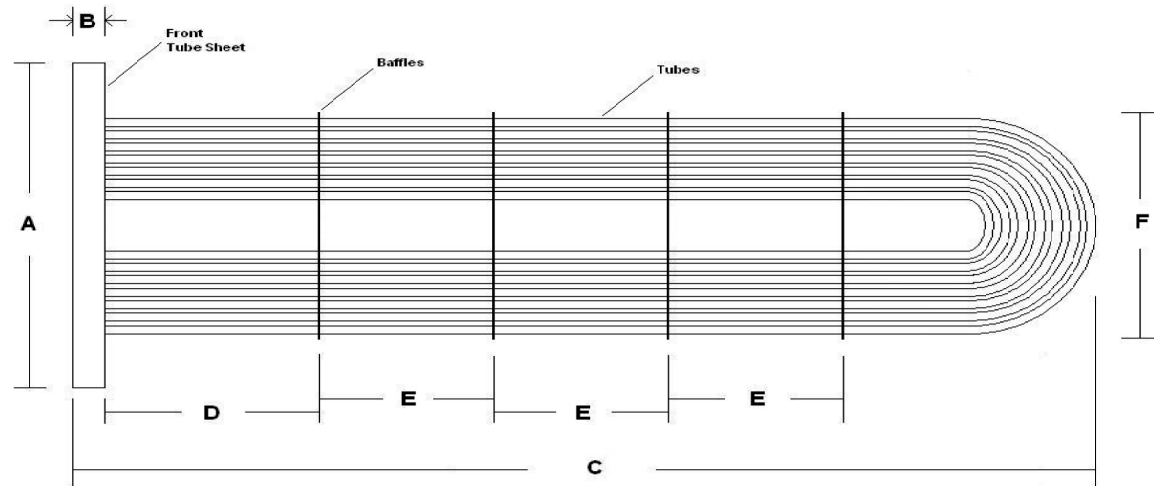

## DIMENSIONAL INFORMATION:

A:	B:	C:	D:	E:	F:
<input type="text"/>	<input type="text"/>	<input type="text"/>	<input type="text"/>	<input type="text"/>	<input type="text"/>

## MATERIALS OF CONSTRUCTION:

FRONT TUBE SHEET:	TUBE OD & THICKNESS:	U-TUBE MATERIAL:	BAFFLES:
<input type="text"/>	<input type="text"/>	<input type="text"/>	<input type="text"/>

## BOLTING INFORMATION: (if applicable)

NUMBER OF BOLTS:	<input type="text"/>
BOLT HOLE DIAMETER:	<input type="text"/>
BOLTING MATERIAL:	<input type="text"/>
BOLT CIRCLE DIAMETER:	<input type="text"/>

## ADDITIONAL INFORMATION:

NUMBER OF U-TUBES:	<input type="text"/>
NO. OF TUBESIDE PASSES:	<input type="text"/>
NOTES:	<input type="text"/>

(Check Appropriate Boxes)	<u>Tubeside</u>	<u>Shellside</u>	<b>CURRENT UNIT:</b>  Manufacturer: <input type="text"/>  Model Number: <input type="text"/>	<b>Contact Information:</b>		 <b>SHCRAFT COMPANY</b> Dallas Office: 214-361-6611 Fax: 214-368-5516 7027 Twin Hills Ave Dallas, TX 75231	
	Water	<input type="checkbox"/>		<input type="checkbox"/>	Company:		<input type="text"/>
	Domestic Water	<input type="checkbox"/>		<input type="checkbox"/>	Name:		<input type="text"/>
	High-Temp. Water	<input type="checkbox"/>		<input type="checkbox"/>	Phone:		<input type="text"/>
	Low-Pressure Steam	<input type="checkbox"/>		<input type="checkbox"/>	Email:		<input type="text"/>
High-Pressure Steam	<input type="checkbox"/>	<input type="checkbox"/>	Date:	<input type="text"/>			